

# Smart Curtain Motor

## User Manual

## Product Introduction

The smart curtain motor enables operations such as opening, closing, and stopping via dry contact and RF signals, RS485 communication and high voltage.

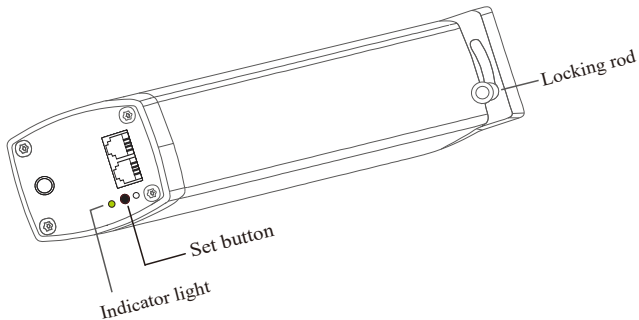

# Motor Installation

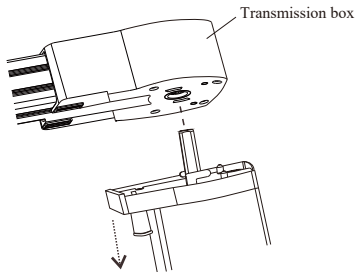

Figure (1)

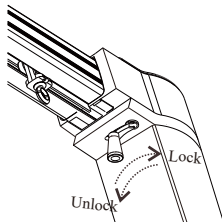
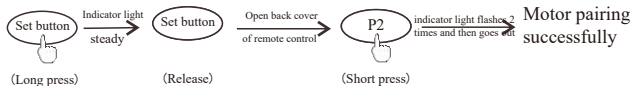
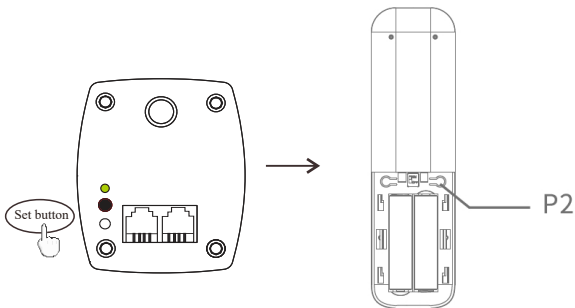

Figure (2)

1. Pull the locking rod down as figure(1), unlock it as figure(2), insert the motor into corresponding transmission box hole.
2. Lock the locking rod as shown in figure(2), and stuck it into the limit hole to ensure the motor is installed in the correct position.

# Remote Control function Settings

## 1 Motor Pairing



# Remote Control function Settings

## 2 Change Direction

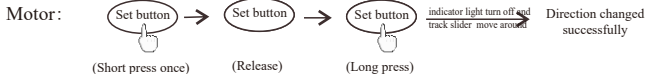
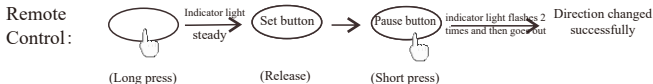
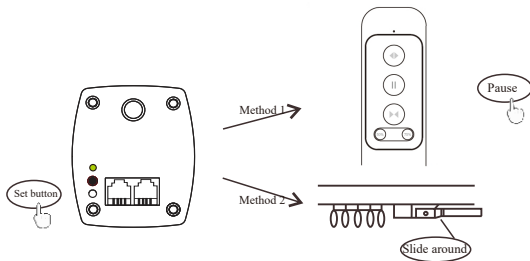

# Remote Control function Settings

## 3 Decode/Delete Route/Restore Factory Setting

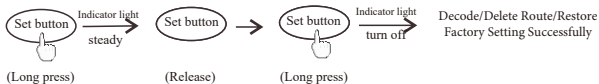
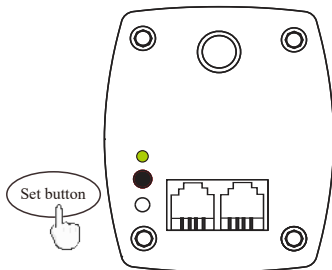

# Dry Contact Wiring Instructions

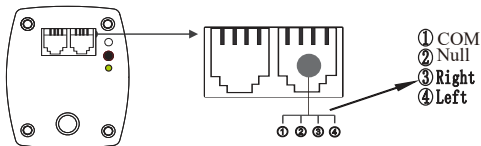

Switching method:

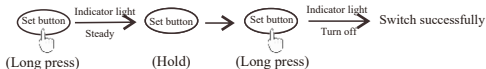

- Mode(1)      ① + ③ Forward/pause      ① + ④ Reverse/pause
- Mode(2)      ① + ③ Press and hold the button, forward, release, pause  
                 ① + ④ Press and hold the button, reverse, release, pause
- Mode(3)      ① + ③ Forward/pause/reverse  
                 ① + ④ Reverse/pause/forward
- Mode(4)      ① + ③ Forward; ① + ④ Reverse; ① + ④ + ③ Pause

(Factory mode default is mode (1), repeat the operations, can automatically switch mode)

# Power Wiring Instructions

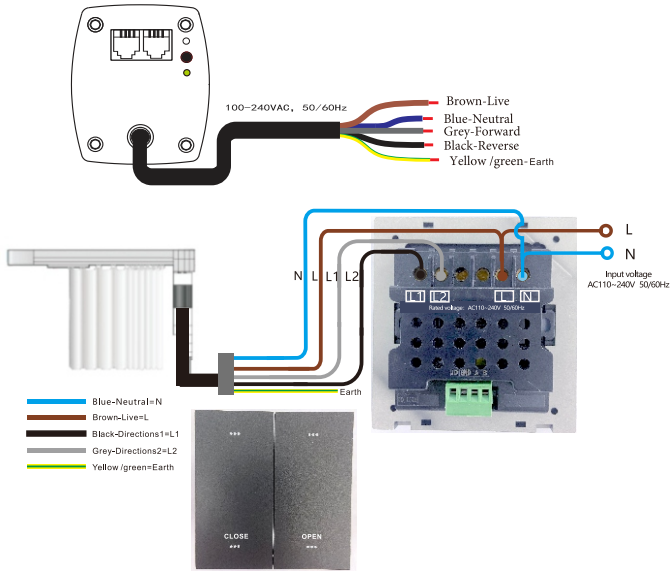



## Attentions

1. Do not soak or wash the product.
2. Please keep the product away from fire, high temperature and other extreme environment.

## Parameters

Product Name	Smart Curtain Motor	Transmitting Frequency	RF, 433MHz	Operating Noise	<35dB
Rated Power	12W/30W	Maximum Load	35KG/60KG	Protection Grade	IP41
Rated Current	0.24A/0.31A	Body Weight	629g/695g	Operating Temperature	-10°C ~ 50°C
Rated Torque	1.2Nm/2.0Nm	Operating Speed	0.14m/s	-	-
Input Voltage	100 ~ 240VAC 50/60HZ		Maximum remote control distance	35m	